



Aveo™

Enjoy practicality.



mylife Aveo™ – the simple and functional blood glucose meter.

- Preset blood glucose monitoring system for fast setup and easy training
- Large numbers and clear display for excellent readability
- Automatic data transfer for quick and simple therapy monitoring
- Connectivity to the mylife™ App for a convenient bolus suggestion
- Strip ejector for hygienic strip removal without contacting blood

The preset meter
with a large display
and strip ejector



More freedom. More confidence. With mylife™.

YPSOMED
SELFCARE SOLUTIONS



Aveo™





Aveo™



mylife Aveo™

A blood glucose meter for every need

mylife Aveo™ is a patient-focused blood glucose monitoring system that meets user requirements: a preset and high quality blood glucose meter with intuitive operation. To help patients manage their diabetes in a reliable and simple way, the mylife Aveo™ blood glucose meter offers suitable functions to fulfill user requirements.

A reliable system which supports the daily diabetes management

After every measurement, a pre-meal, post-meal or fasting marker can be set. To help better interpret their results, a blood glucose target range can be defined too. After every measurement, an icon will indicate if the blood glucose level is beyond the defined blood glucose target range or not. With mylife Aveo™, up to three alarms can be set to remind the user when a test needs to be performed. Furthermore, a post-prandial alarm reminds the user to perform a test two hours after a meal. For safety reasons, a strip expiry date indicator can be set, which calls the user's attention when the current test strip has expired.

High measurement practicability in just a few steps

Safe and easy application makes mylife Aveo™ the ideal blood glucose meter for patients of any age. The device activates automatically when a test strip is inserted and identifies the strip code (see Autocoding). An audible signal confirms the correct insertion of the test strip. Measurement results are easy to read thanks to large numbers and the well illuminated display. The strip ejector allows a removal of the test strip without contacting blood.

An intelligent blood glucose meter integrated in a whole system

For people with diabetes who wish to additionally manage their diabetes via a mobile device or a therapy management software, measurement data can automatically be transferred via Bluetooth® to the mylife™ App (iOS/Android) and via micro-USB to different therapy management software, such as the mylife™ Software. The mylife™ App allows users to track their own blood glucose measurements. Furthermore, the settings are synchronised between the blood glucose meter and the mylife™ App.

Between simple and all options

The mylife Aveo™ blood glucose monitoring system suits people with diabetes who appreciate an easy-to-use meter with a large display, but also people who want to manage their diabetes with the support of mobile devices.



mylife Aveo™

Components at a glance



mylife Aveo™ blood glucose meter

- Preset and easy-to-use meter with intuitive operation
- Well illuminated and large display with big numbers for excellent visibility from all viewing angles
- Possibility of blood glucose target range definition
- Alarm functions with 3 daily alarms
- Post-prandial alarm (2 hours)
- Strip expiration date indicator
- Pre-meal, post-meal and fasting marker
- Strip ejection without contacting blood
- Shortcuts printed on the meter's reverse side for fast settings
- Bluetooth® and micro-USB for data transfer to the mylife™ App and to therapy management software, such as the mylife™ Software
- Automatic data transmission to a smartphone with installed mylife™ App



mylife Aveo™ lancing device

- Lancet ejector for safe and easy lancet changes
- Practical bayonet lock and stop function for easy lancet replacement
- Vibration-absorbing design for precise penetration of the skin and thus minimal puncture injury
- 9 variable puncture depths
- Gentle collection of blood samples



mylife Aveo™ test strips

- High accuracy¹ and precision² with Glucose Dehydrogenase-Flavine Adenine Dinucleotide (GDH-FAD) enzyme
- Standard round test strip boxes containing 50 strips



mylife Aveo™

Matches the mylife™ YpsoPump® and pen therapy

mylife Aveo™ is ideal for diabetes self-management when combined with the mylife™ YpsoPump® insulin pump: both devices can transfer data wirelessly to the mylife™ App via Bluetooth®. Plus, with the mylife Aveo™ people on pen therapy have the possibility to send their blood glucose data wirelessly to the mylife™ App for bolus suggestions. Regardless of the therapy form, the mylife™ App allows its users to manage their therapy data in one central management solution – providing users with a comprehensive and quick therapy overview. The optional mylife™ Cloud makes data synchronisation between healthcare professionals and patients very easy.

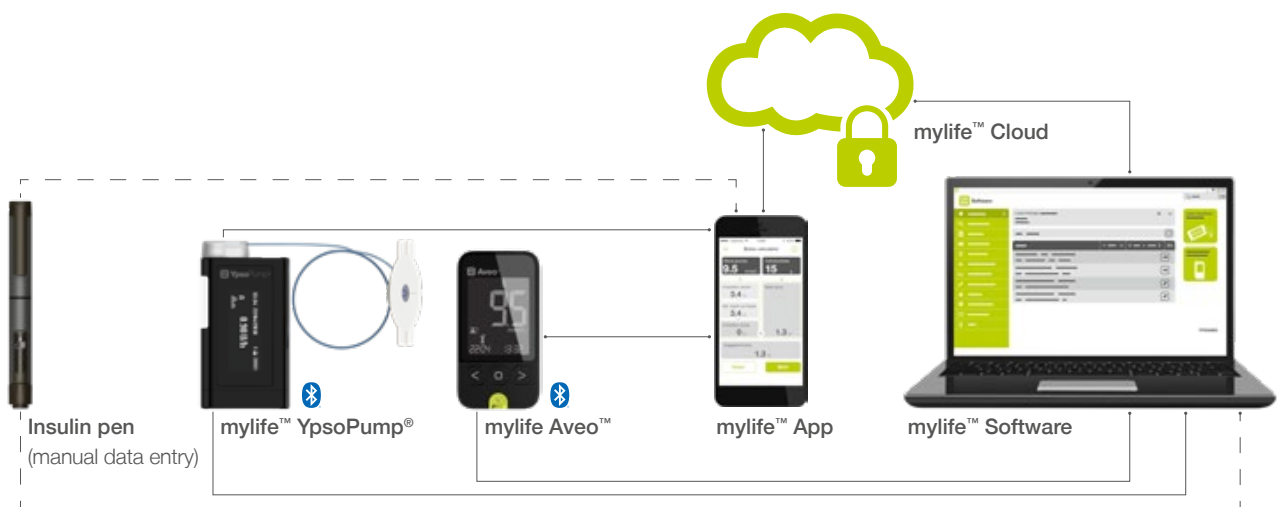

mylife™ Digital

Therapy management made easy

The mylife™ therapy management solution is designed to adapt to an on-the-go lifestyle. Users can access diabetes therapy data via the mylife™ App and via their personal computer in the mylife™ Software and in the mylife™ Cloud.

- Intuitive and user-friendly design for ease-of-use
- Identical interface for all users to simplify communication
- Optional use of cloud service to match user preferences
- Possibility of data sharing to simplify therapy management



Download the mylife™ App directly from the Apple App Store or Google Play Store and find more information about the mylife™ Software on your mylife™ Diabetescare website:

www.mylife-diabetescare.co.uk/digital

**mylife Aveo™**

For reliable accuracy and precision

Autocoding

Autocoding stands for the automatic calibration of the meter. Modern blood glucose monitoring systems correct each measurement automatically to compensate production tolerances of the test strip lots regarding chemistry and physics. Each individual test strip gets a lot-specific electronic code during production, which is read by the meter to correct the measured blood glucose value as close as possible to the reference device. The patient does not have to calibrate the meter manually in any way.

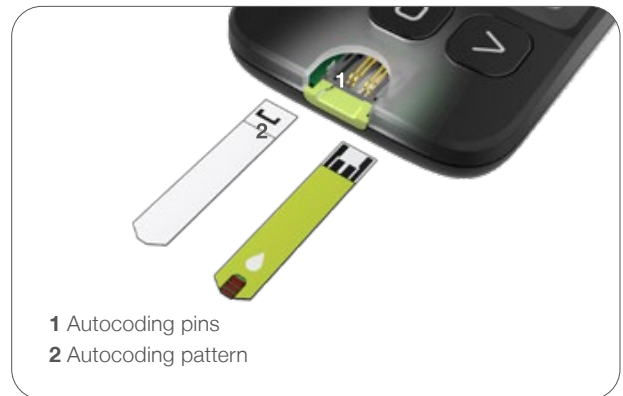

In the context of the requirements of ISO 15197:2013³, the mylife Aveo™ measuring technique leads to convincing results:

System accuracy¹

ISO 15197:2013 demands $\geq 95\%$ of measurements within ± 0.83 mmol/L at a glucose concentration < 5.55 mmol/L and within $\pm 15\%$ at a glucose concentration ≥ 5.55 mmol/L. All three reagent system lots achieved 99.7% within ± 0.83 mmol/L and $\pm 15\%$. 100% of mylife Aveo™ test results (600 of 600 pooled measurements) cover zone A in the Consensus Error Grid (CEG) (A and B zones must be $\geq 99\%$).

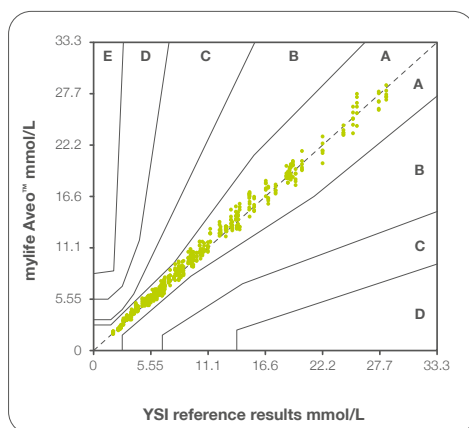
**Definition of the error grid zones:**

- Zone A** No effect on clinical action
- Zone B** Altered clinical action – little or no effect on clinical outcome
- Zone C** Altered clinical action – likely to affect clinical outcome
- Zone D** Altered clinical action – could have significant medical risk
- Zone E** Altered clinical action – could have dangerous consequences

Measurement precision²

mylife Aveo™ shows very good results when tested for measurement repeatability (ten meters, 3 test strip lots at 5 glucose ranges): $SD \leq 0.2$ mmol/L (TNO⁴ acceptance criteria: $SD \leq 0.56$ mmol/L at glucose concentrations < 5.55 mmol/L) and $CV \leq 3.7\%$ (TNO criteria: $CV \leq 5\%$ at a glucose concentration ≥ 5.55 mmol/L).

**Aveo™**

mylife Aveo™

Technical data and product features

Product specifications

Measurement technology	Electrochemical sensor GDH-FAD
Reference device	YSI 2300 Stat Plus
Measurement calibration	Plasma
Coding	Autocoding (no user interaction required)
Sample	Capillary and venous whole blood
Haematocrit	15–70 %
Minimum sample volume / Test time	0.5 µL / 5 seconds
Memory capacity	1 000 measurements
Measuring range	0.6–33.3 mmol/L, if outside: LOW or HIGH
Power saving	On
Operating temperature	5–45 °C
Operating relative humidity	10–90 %
Power supply / Meter battery life	2 CR2032 batteries / 1 000 measurements
Meter dimension / Meter weight	103 × 54 × 15 mm / 67 g (with batteries)
Monitor	LCD display with backlight
Data interface	Option A: wireless via Bluetooth® (transmission range approx. 10 m) Option B: micro-USB port (micro-USB/USB-A-type cable, separately available)
Meter data transmission management	Data can be transferred to the mylife™ App and to different therapy management software, such as the mylife™ Software



mylife Aveo™ and accessories

Product overview

	Item	Code	PIP-Code
Blood glucose monitoring starter set	mylife Aveo™ set	700017365	–
Test strips	mylife Aveo™ test strips	700017358	379-5234
Lancets	mylife™ Lancets, 30G	7101030	367-6038
	mylife™ Lancets multicolor, 30G	7101031	363-6644
	mylife™ SafetyLancets, 28G/1.5 mm	7100031	367-6038
	mylife™ SafetyLancets Comfort, 30G/1.2 mm	700001495	400-9155
Accessories	mylife™ micro-USB cable	700012330	–
	mylife™ Dongle	700001746	–

1 i-SENS: Test Report for the System Accuracy Evaluation Blood Glucose Monitoring System mylife Aveo™, Yangjae Choi's Hospital, Korea, 10.2019.

2 i-SENS: Test Report for the Evaluation of Precision (ISO 15197:2013) of the mylife Aveo™ Blood Glucose Monitoring System, Sensor laboratory (B1F) Seocho, i-SENS, Inc., Korea, 10.2019.

3 ISO 15197:2013; In vitro diagnostic test systems – Requirements for blood-glucose monitoring systems for self-testing in managing diabetes mellitus. International Organisation for Standardisation, Geneva.

4 Post H. et al.: Portable In-Vitro Blood Monitor Systems for (Self)-Monitoring-Blood Glucose Monitors – Particular Requirements and Test Methods. TNO Quality Guideline PG/TG/2001 045 2001. Delft: TNO, 2001.



Diabetescare

More **freedom.**
More **confidence.**
With **mylife™.**



Infusion systems



Blood glucose monitoring systems



Therapy management



Pen needles

With its mylife™ Diabetescare brand, Ypsomed offers a comprehensive portfolio of products and services for people with diabetes. This allows users easy, discreet and reliable self-treatment. With mylife™ Diabetescare, self-treatment becomes simpler and easier.

Ypsomed Ltd. // 1 Park Court // Riccall Road // Escrick // North Yorkshire // YO19 6ED //
info@ypsomed.co.uk // www.mylife-diabetescare.co.uk // Customer Care: 0344 856 7820
(Calls to this number are free of charge from mobile phones and landlines,
plus your phone company's access charge.)

10207923-UK-en/V01